

INVIS®

Invis joining element to glue



Invis joining element to glue 12 mm

Art. No. 6012008



Invis joining element to glue 8 mm

Art. No. 6008008

For the complete selection of studs please order our catalogue or download it from - www.lamello.com



Advantages:

- No thread-cutting in hard materials* necessary
- Up to 20% lower price
- No splitting pressure in thin material
- Better pull-out strength in porous materials:

Comparison tensile-breaking strength in a chipboard 19 mm

Joining element with wood thread 12 mm	899 N
Joining element to glue 12 mm with Invis glue Ergo	2160 N

Applications:

- Same applications as joining elements with thread
- Additional use in materials in which no thread can be cut
- Application in thin materials possible (no pressure..)
- Application in miscellaneous hard materials* possible

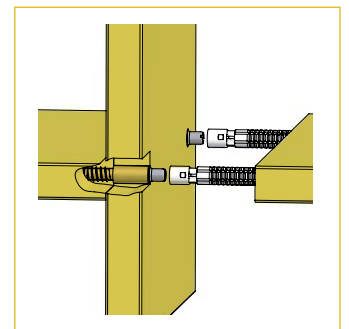

* Corian, Varicor, HPL, VKP, Perspex, Aluminium



Invis is protected by US and international patent law Invis® is a registered trademark of the Lamello AG

1. Holes for joiners to glue

Mill holes very precisely same as for dowels. Place drill holes as close as possible, but not more than 20 resp. 10 mm from the surface.

Attention: Hole depth 48 mm!

2. Holes for studs

Depending on material and construction different studs are used. If the stud needs to be glued as well, a bush with a M6 inside thread needs to be glued in and the stud with metric thread is used.

Attention: Blow out the holes!

3. Choose the glue

Lamello suggests the use of Ergo 5713 from Kising AG and Mirapur 9500 from Geistlich. Both glues can be ordered in small quantities for tests. Generally PUR glues are suitable.

Attention: Don't use PVA glue!

4. Glue application

Apply the glue approx. 5 mm from the hole edge. Glue amount max. 0.5 g per joining element.

5. Inserting of the joiners to glue

Press the joining element into the hole by hand or with the inserting tool so it is flush or 0.5mm recessing

Attention: Never drive it in with a hammer!



Inserting tool for joining elements to glue for system 8 and 12 mm
Art. No. 6100080

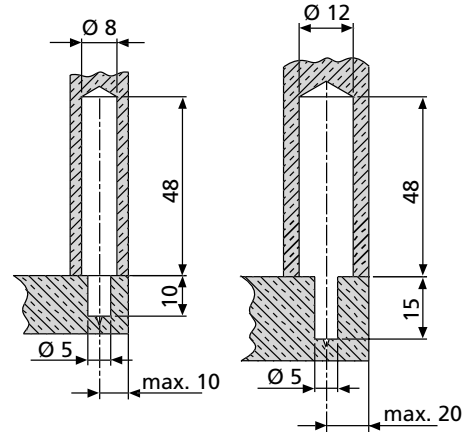

Mirapur 9500 speed, 80 ml
Hardening: 24 h
Art. No. 6100025



Ergo 5713, 20 g
Hardening: 15 min
Art. No. 6100024

